

PRODUCT INFORMATION:

The 0909 is a compact and flexible lighting solution. Available with multi-volt (9V to 108V) or single volt options, it has a contemporary design which complements any machine. A practical and small light, the 0909 is also available as an E-Approved rated model and can be mounted in a variety of locations on your machine.



- EMC TESTED
- IP69K
- VIBRATION TESTED
- SALT SPRAY TESTED
- E RATED OPTIONAL
- UL RATED OPTIONAL

Operating Temp: -40°C to 85°C,
-40°C to 75°C

Light Pattern:
Symmetric, Asymmetric

Lens Material: Plastic

Housing: Cast Aluminium

Mounting Options:
Hanging, Standing, Side

Connector:
Deutsch (DT04-2P) built in

Weight: 616 g / 1,36 lb

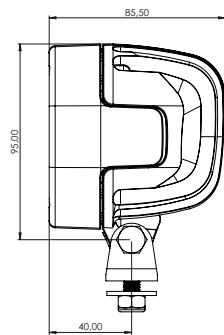
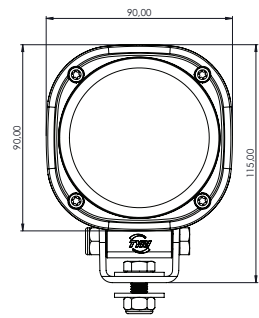

LUMEN OUTPUT		Number of LED'S	VOLTAGE		AMP DRAW		Power (Watts)	Colour Temp	CRI	COMPLIANCE / RATING						
Theoretical	Effective		Machine	Operating Range	12 Volts	24 Volts				EMC EN55025 / CISPR25	IP69K	Vibration 5-2000Hz 3 Axis	Salt Spray ASTM B117	UL Rated Optional	E Approved Optional	Shock Tested
1800	1400	6	12	9 16	1.8		22	5700	70	5	•	8 Grms	•	•	E-R23	
1800	1400	6	24	18 32		0.9	22	5700	70	5	•	8 Grms	•	•	E-R23	
1800	1400	6	12-80	9 108	1.3	0.6	24	5700	70	5	•	8 Grms	•			
2250	1850	6	12	9 16	2.3		29	5700	70	5	•	8 Grms	•			
2250	1850	6	24	18 32		1.2	29	5700	70	5	•	8 Grms	•			
2250	1850	6	12-80	9 108	2.0	0.9	22	5700	70	3	•	8 Grms	•			50g 10ms