



0910A Marker LED

PRODUCT INFORMATION:

This square, dual sided, turn marker is commonly placed on fenders and cabs of vehicles. It's primary use is to clearly indicate the direction the machine is turning and is mounted via pedestal or hanging mount.

Number of LEDs: 27

Voltage machine: 24V

Operating Temp: -40° to 75°C

Lens Material: Plastic

Housing: Plastic

Mounting Options:

Bolt through housing

Connector: Bare Wires

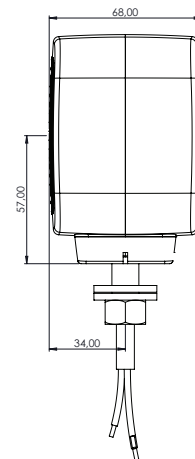
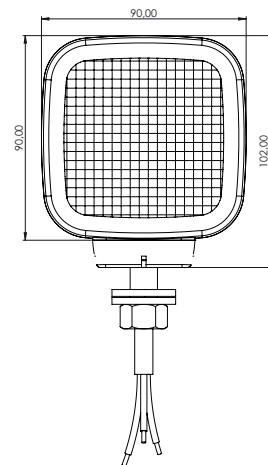

Product may not be available in all territories; please check with your local TYRI office