



# 1010 WhitePoint

## PRODUCT INFORMATION:

The WhitePoint is a tighter spot light, in comparison to the WhiteBeam, and capable of projecting light over a long distance at a high Candela output. This work light is suitable for applications requiring illumination at far distances.



EMC TESTED

Operating Temp: -40°C to 75°C



IP69K

Light Pattern: Spot



VIBRATION TESTED

Lens Material: Plastic

Housing: Cast Aluminium

Dampened



SALT SPRAY TESTED

Mounting Options: Hanging, Standing, Side, Flush

Connector:

Deutsch (DT04-2P) built in

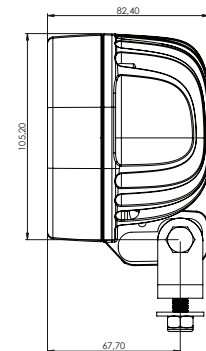
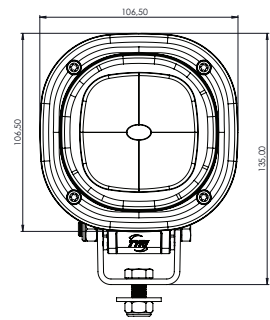

LUMEN OUTPUT		Number of LED'S	VOLTAGE		AMP DRAW		Power (Watts)	Colour Temp	CRI	COMPLIANCE / RATING						
Theoretical	Effective		Machine	Operating Range	12 Volts	24 Volts				EMC EN55025 / CISPR25	IP69K	Vibration 5-2000Hz 3 Axis	Salt Spray ASTM B117	UL Rated Optional	E Approved Optional	Shock Tested
900	700	4	12-48	9 60	1.4	0.6	17	5700	70	5	•	10 Grms	•			
1100	900	4	12-48	9 60	1.4	0.6	17	5700	70	5	•	10 Grms	•			